

80 Series Front Indicator/DRL

- Retro fit to existing 4x4 bullbar
- ECE Australian Road Approved
- Fully submersible
- 5 Year Warranty

ECE
Approved
100%
Waterproof
5 Year
Warranty

Function Front Indicator Front Marker Daytime Running use
Part No. *DRLHOTDOG

Size 80mm Round x 40mm

Voltage Voltage Specific 12 Volt

LED Qty 34

Cable 340mm cable

Draw @13.8V	Ind	DRL	Marker
	0.32A	TBA	0.03A

Approvals	Function	Approval	CTA
ECE	Front Ind	1-E9-01.11725	060217
ECE	Marker	A-E9-02.11725	060217
ECE	DRL	RL-E9-00.11725	060217



P/N 80AW - 12 Volt, Blister

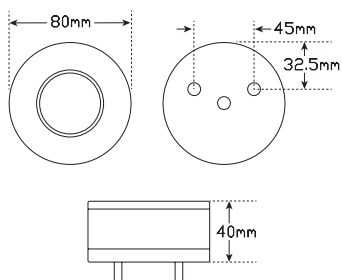

*DRLHOTDOG

**To use as Daytime Running Lamp
You must use DRLHOTDOG.**



Fitting Instructions

Fit to existing bullbar applications. Please refer to ADR 13/00 for mounting instructions. **Wire Colour Code** - Brown - Position, Yellow - Indicator, White - Earth, Blue/Red - To be used for DRL function in conjunction with Part No DRLHOTDOG

Daytime Running Lamp Modules

- To Suit LED Autolamps range of DRL products
- Converts into ECE approved functioning DRL
- Hard wearing, heavy duty construction
- Wire, 22AWG with tinned plating
- IP67 Dust & Waterproof
- Voltage Range 9-30 Volt

Function	DRL Module
Size	105mm x 25mm round
Voltage	Multivolt 9-30V
Power	21 Watt
Cable	200mm each side

Suits the following part numbers:

80AW
175AWTB2



Part No.
DRLHOTDOG-2 - Twin Blister
DRLHOTDOG - Single Bulk

To be used in conjunction with LED Autolamps range of daytime running lamps.
Converts them into an ECE Approved functioning DRL.

1) Vehicle Start - DRL on, 2) Indicator On - DRL dims, 3) Headlight or Park On - DRL dims. **Note:** Ensure the correct end is wired to the lamp.
LED recommends this product to be installed by a qualified Auto Electrician.

See our website, www.ledautolamps.com for more information.

Wire Colour

Red - DRL
Brown - Position (Headlight)
Yellow - Indicator
White - Earth

