

**autolamps**

**JUST ARRIVED**

**Front Indicator/Marker  
Lamp with Accessory Daytime  
Running Function\***



Front Indicator and marker lamp with daytime running accessory function when used in conjunction with Part Number: DRLHOTDOG

- **Retro fit to existing 4x4 bullbar**
- **ECE Australian Road Approved**
- **Fully submersible**
- **5 Year Warranty**

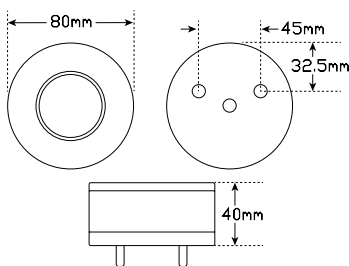

\*DRLHOTDOG

Specifications				
<b>Part No</b>	80AW	80AWB	80AW24	DRLHOTDOG
<b>Package</b>	Blister single	Poly Bag	Blister single	Box
<b>Function</b>	Front Indicator Front Marker Daytime Running use Part No. *DRLHOTDOG	Front Indicator Front Marker Daytime Running use Part No. *DRLHOTDOG	Front Indicator Front Marker Daytime Running use Part No. *DRLHOTDOG	Enables 80AW, 80AWB & 80AW24 to be used as Daytime Running lamp
<b>LED Qty</b>	34	34	34	N/A
<b>Voltage</b>	12 Volt	12 Volt	24 Volt	12/24 Volt
<b>Cable</b>	40cm Sheathed	40cm Sheathed	40cm Sheathed	19cm each side

All enquiries P: (03) 9466 7075, E: led@ledtech.com.au, www.ledautolamps.com

DISCLAIMER - LED Technologies Pty. Ltd. have made every effort to ensure that the information is correct and accurate at the time of printing. Print Date March 2015

## To Be Used in Conjunction with LED Autolamps Daytime Running Lamp Range of Products

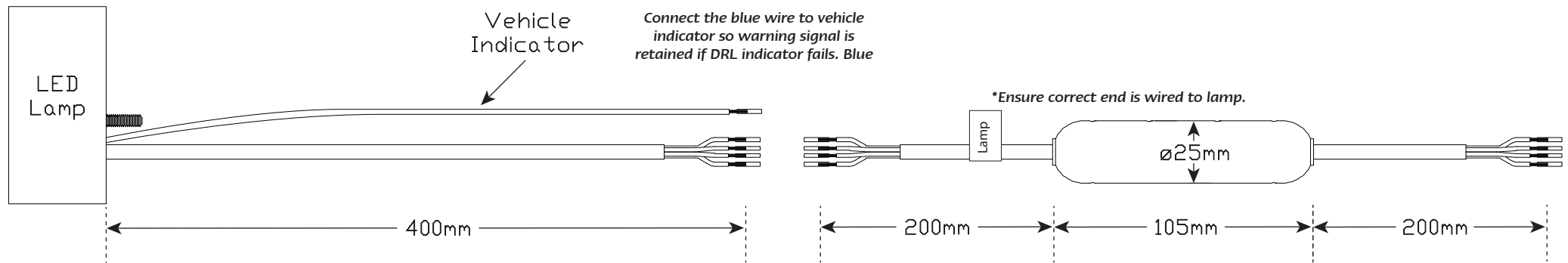

Wire colour	
Blue	Vehicle Indicator
Red	DRL*
Brown	Position
Yellow	Indicator
White	Earth

*\*Vehicles that do not come standard with a Daytime Running Lamp will require a DRL module to be sourced and fitted separately.*

*Please refer to your vehicle manufacturer for more information.  
LED Autolamps recommends these products to be fitted by a qualified Auto Electrician*



### DRLHOTDOG Fitting Instructions

Products that require  
DRLHOTDOG to function  
as a daytime running lamp:



175AWTB2



80AW