

80 Series Front Indicator/DRL

- Retro fit to existing 4x4 bullbar
- ECE Australian Road Approved
- Fully submersible
- 5 Year Warranty

ECE
Approved

IP67
Protection

5 Year
Warranty

Function Front Indicator Front Marker Daytime Running use
Part No. *DRLHOTDOG

Size 80mm Round x 40mm

Voltage Voltage Specific 12 Volt or 24 Volt

LED Qty 34

Cable 340mm cable

Draw @13.8V	Ind	DRL	Marker
	0.32A	TBA	0.03A

Approvals	Function	Approval
ECE	Front Indicator	1-E9-01.11725
	Marker	A-E9-02.11725
	DRL	RL-E9-00.11725



P/N 80AW - 12 Volt, Blister
P/N 80AW24 - 24 Volt, Blister
P/N 80AWB - 12 Volt, Box

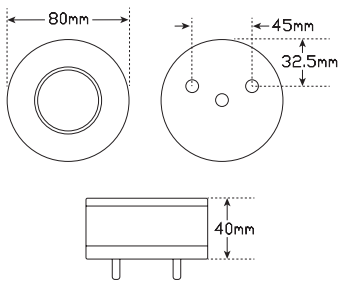

*DRLHOTDOG



Fitting Instructions

Fit to existing bullbar applications. Please refer to ADR 13/00 for mounting instructions.



All enquiries P: (03) 9466 7075 E: led@ledtech.com.au, www.ledautolamps.com

All efforts are made to ensure all information is correct and up to date, it can be subject to change without notice. All measurements are in millimeters (mm) and are not to scale.

© All LED Technologies designs are registered throughout the world. - Current as of 18/02/2019

To Be Used in Conjunction with LED Autolamps Daytime Running Lamp Range of Products

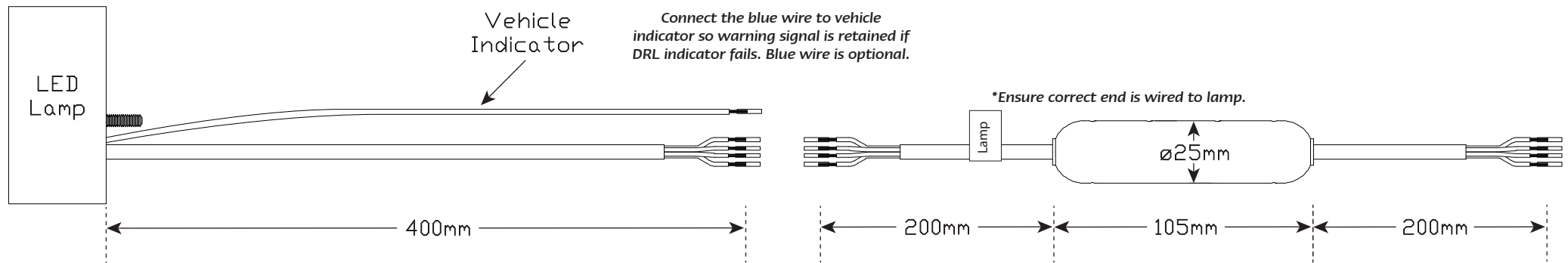

Wire colour	
Blue	Vehicle Indicator
Red	DRL*
Brown	Position
Yellow	Indicator
White	Earth

*Please refer to your vehicle manufacturer for more information.
LED Autolamps recommends these products to be fitted by a qualified Auto Electrician*



DRLHOTDOG Fitting Instructions

Products that require DRLHOTDOG to function as a daytime running lamp:



175AWTB2



80AW