

New Harness & Lighting System
for large trucks and trailers

Original Harness & Lighting System
for box, tandem and boat trailers

New for 2017 - LED Autolamps Unique

Functional, Long Lasting Quality, Value for Money

Innovated Harness System

The key to this system is its flexibility by offering every conceivable option for various lighting functions to be added at any point in the truck harness line.

Flexibility

Cable lengths from 0.25m to 15m combining heavy duty connector covers for every plug and connector assembly point with a breaking strain in excess of 25kg, making this a heavy duty robust truck harness assembly.

Colour Coded

All assembly plugs are colour coded to its specific function. Example - The Brown plug is for Marker Lamps. When requiring a marker lamp, add a brown plug in the harness line, add the desired length 2 core cable and plug into the desired marker lamp. The Yellow (LHS) or Green (RHS) plug is for Side Direction Indicator Lamps. When requiring a Side Direction Indicator lamp, add a yellow or green plug whether left or right hand side in the harness line, add the desired length 2 core cable and plug into the desired Side Direction Indicator lamp.



- Add any Light Anywhere in the Harness System
- Heavy Duty Water Proof Cable, Plugs and Connectors
- Colour Coded Plugs to the colour of the wire function
- All Lights Compliant with ECE or ADR
- Cable System Compliant with Dangerous Goods (AS2809)
- 5 Year Warranty, Livestock Transport 1 Year Warranty
- RoHS Compliant Cables, Plugs and Lights

Heavy Duty Harness System

Cable and Wire

TWP Cable (Thin wall thermo plastic) and PVC Automotive primary wire complying with SA-J1128, Annealed copper wire in compliance with ASTM B3, RoHS compliant Lead free copper wire with operating temperature between -40°C to +85°C - Harness system tested to B Double requirements when LEDs are used. Please refer to wire gauge table for further information regarding wire gauge and amperage.

DG Rating

Cables and covers are manufactured to comply with DG (Dangerous Goods) Rating. Inspected by worksafe Victoria and is accordance with DG-150424-1, DG-150424-2 in relation to the electrical wiring requirements as it applies to dangerous goods road vehicle bulk tankers, in accordance for usage with petrol and gas tankers. Cabling and lighting complies with AS2809 parts 1 & 2.

Labour Costs

Designed specifically to be easily and quickly installed without the need to cut, splice, solder, join or tape wire joins, reduces fitting times with its simple plug in design allowing skilled or non-skilled fitters to complete the install. Expect to reduce lighting assembly labour costs by up to 75%.

Warranty

Five Year Warranty for all truck and trailer vehicles and a one year warranty for livestock carrying trailers.

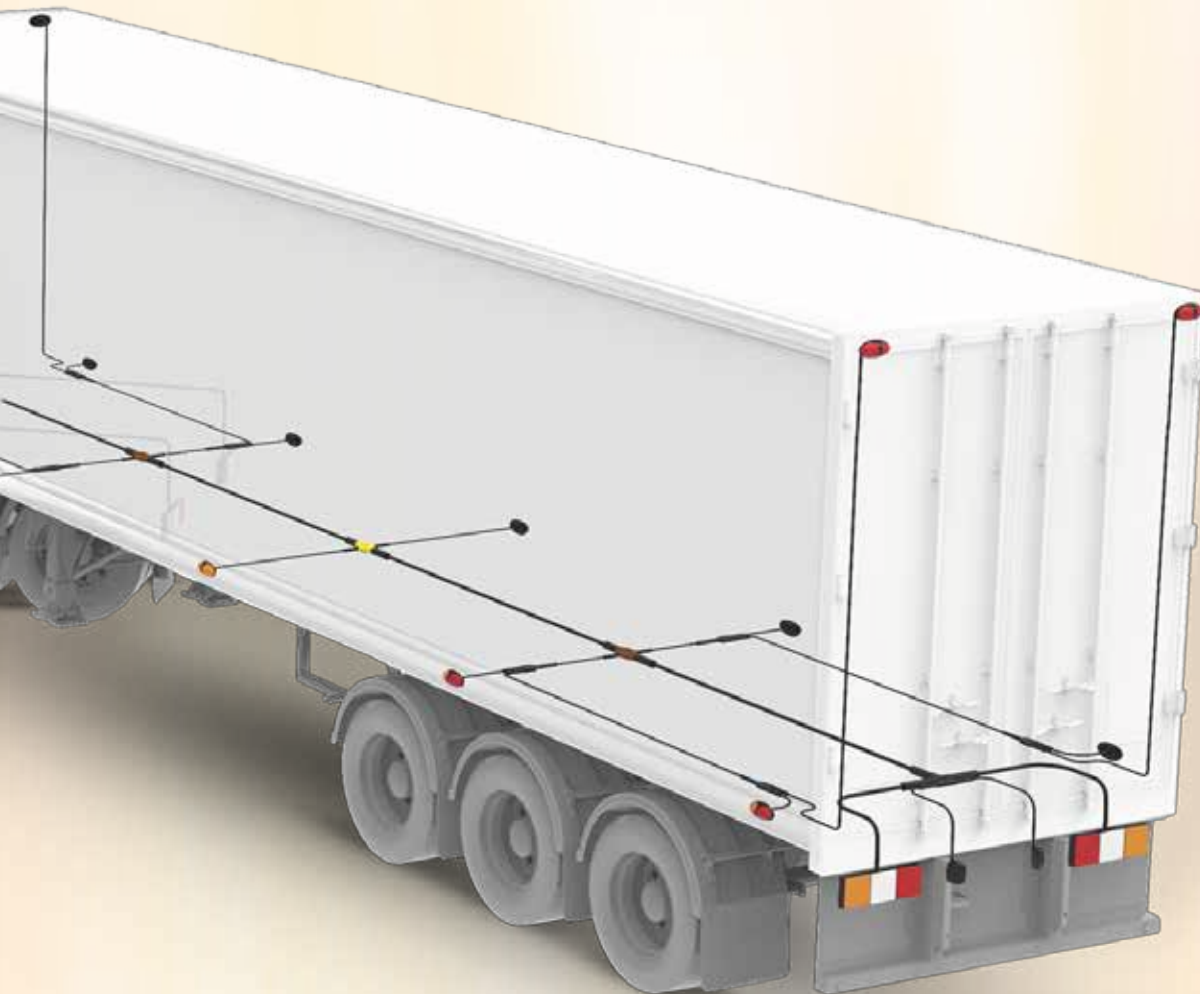

Heavy Duty Truck & Trailer Harness and Lighting System



Functional, Long Lasting Quality and Value for Money

Innovated Harness System

The key to this system is its flexibility by offering every conceivable option for various lighting functions to be added at any point in the truck harness line.

Flexibility

Cable lengths from 0.25m to 15m combining heavy duty connector covers for every plug and connector assembly point with a breaking strain in excess of 25kg, making this a heavy duty robust truck harness assembly.

DG Rating

Cables and covers are manufactured to comply with DG (Dangerous Goods) Rating. Inspected by worksafe Victoria and is in accordance with DG-150424-1, DG-150424-2 in relation to the electrical wiring requirements as it applies to dangerous goods road vehicle bulk tankers, in accordance for usage with petrol and gas tankers. Cabling and lighting complies with AS2809 parts 1 & 2.

Labour Costs

Designed specifically to be easily and quickly installed without the need to cut, splice, solder, join or tape wire joins, reduces fitting times with its simple plug in design allowing skilled or non-skilled fitters to complete the install. Expect to reduce lighting assembly labour costs by up to 75%.

Warranty

Five Year Warranty for all truck and trailer vehicles and a one year warranty for livestock carrying trailers.

7 Core Main Cable Specifications

The cable we have chosen for this harness system is used widely in the automotive industry and complies with SA-J1128 Standards.

The plugs we have designed are 100% water proof and pass IP68 Standards, our unique double ridged male plugs ensure complete water proofing by doubling the protection from water ingress.

Plugs have been designed with a special water proof double sealing lip which will not allow water ingress

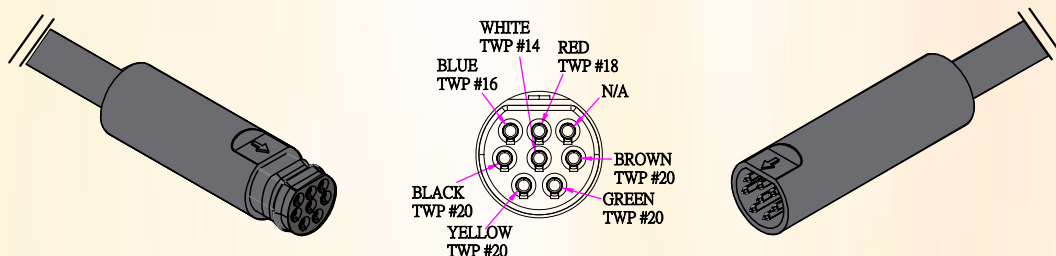

Cable Width 9.5mm, Male & Female plug Diameter 18mm Combined length of plugs when joined 106mm

The cover for the plugs have been created for extra strength and engineered to a breaking strain of 25 kg.

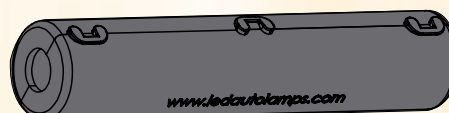

Part No. CMC, Cable Cover Dimensions, Diameter 22mm, Length 110mm

Heavy Duty Truck & Trailer Harness and Lighting System



Cable Lengths with Male Plug and Bare Wires, use from the front of trailer

Part No

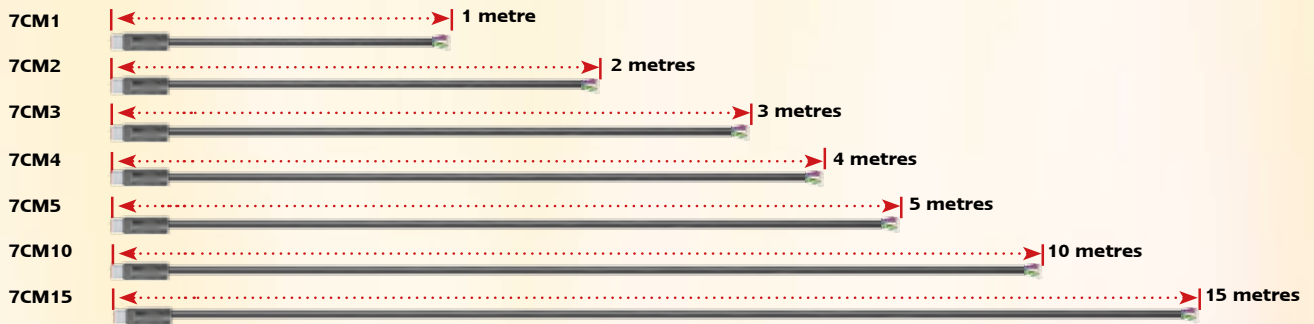

Cable Length with Female Plug and Bare Wires, when using other brand rear lamps



Cable Lengths with Male and Female Plugs, use when adding lighting function plugs

Part No

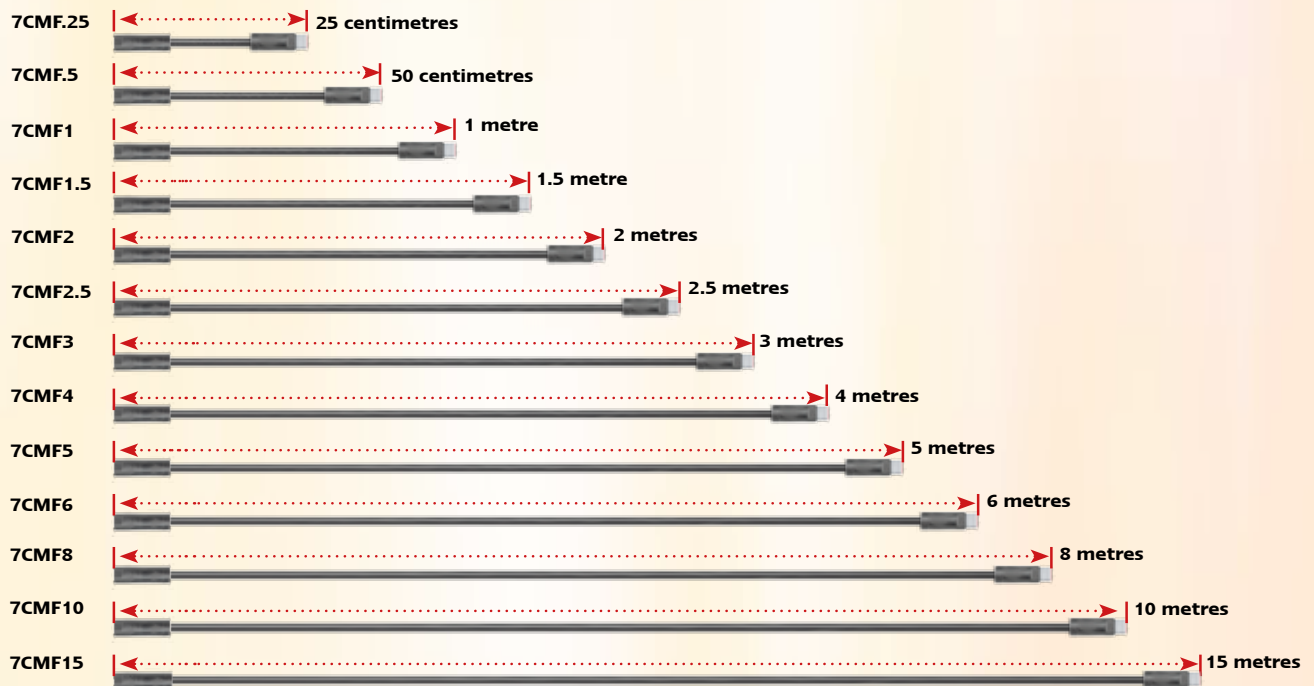

Wire specifications

Function	Wire Colour	Gauge	Rated Amp	Draw @13.8V	Maximum Lamps	Diameter (mm)	Area (mm ²)	Resistance
Earth	White	14	20	-	-	1.62814	2.08	2.525
Brake	Blue	16	10	2.0A	4 Units	1.29032	1.31	4.016
Stop	Red	18	8	0.47A	16 Lamps	1.02362	0.823	6.385
Left Indicator	Yellow	20	5	0.42A	10 Lamps	0.8128	0.518	10.15
Right Indicator	Green	20	5	0.42A	10 Lamps	0.8128	0.518	10.15
Marker	Brown	20	5	0.05A	120 Lamps	0.8128	0.518	10.15
Reverse	Black	20	5	0.59A	8 Lamps	0.8128	0.518	10.15

Heavy Duty Truck & Trailer Harness and Lighting System



7 Core Cable Splitter

The 7 Core cable splitter has many functions, it can be used to add another rear combination lamp to an existing rear combination lamp it is basically a 7 Core cable split into two 7 core cables giving you the ability to continue the harness cable in any manner you desire before terminating with a final rear combination lamp assembly. Example on opposite page.

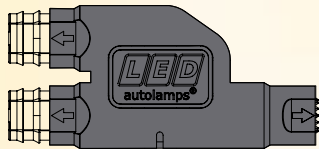

Part No. 7P3W Plug Dimensions
Width 94mm, Length 44mm

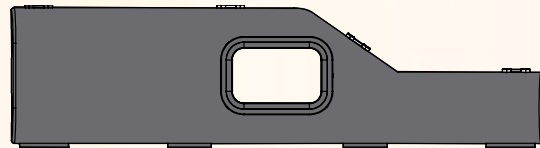

Part No. 7PC Cover Dimension
Width 194mm, Length 60mm

7 Core Rear Junction Splitter

The rear junction splitter has been designed to split the 7 core cable into a left and right side for rear lighting functions of Stop/Tail, Indicator and Reverse. The rear junction splitter also has a left and right side 2 pin plugs for the connection of licence plate lamps and marker lamps. Example on opposite page.

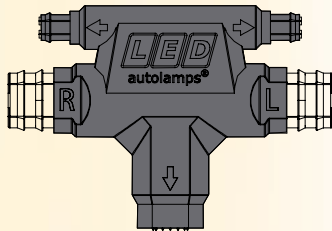

Part No. 7CJ Plug Dimension
Width 89mm, Length 61mm

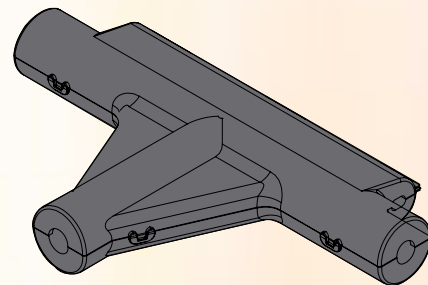

Part No. CCJ Plug Cover Dimension
Width 189mm, Length 116mm

7 Core Rear Junction Extension

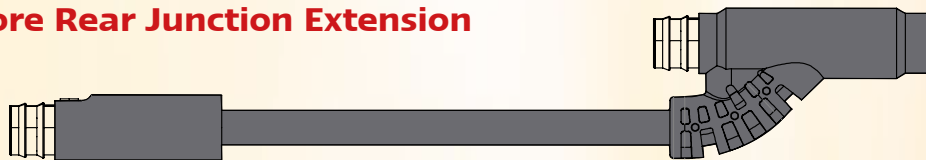

Part No. 7CLC Dimensions
Length 200mm

The 7 Core Rear Junction Splitter Extension is used with the 7 core rear junction splitter (Above) for the purpose of connecting a 7 pin trailer base at the rear of the trailer, its purpose is for the ability to connect another trailer to the existing harness system (B-Double). Example on opposite page.

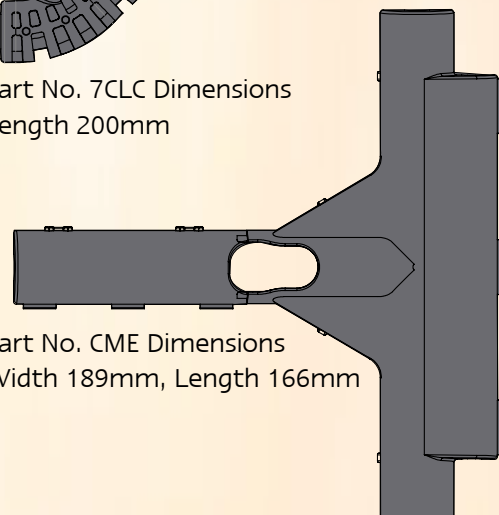

Part No. CME Dimensions
Width 189mm, Length 166mm

Heavy Duty Truck & Trailer Harness and Lighting System



7P3W

7 Core cable and plug to rear combination lamps

7P3W

7 Core cable from the front of the vehicle or from the 7CJ Main cable splitter

7 Core cable and plug to rear combination lamps



7CJ

2 Core cable and plug to licence plate lamps and marker lamps

7CJ

2 Core cable and plug to licence plate lamps and marker lamps

7 Core cable and plug to RHS rear lamps

7 Core cable and plug to LHS rear lamps

7 Core cable from the front of the trailer to 7CJ main cable splitter

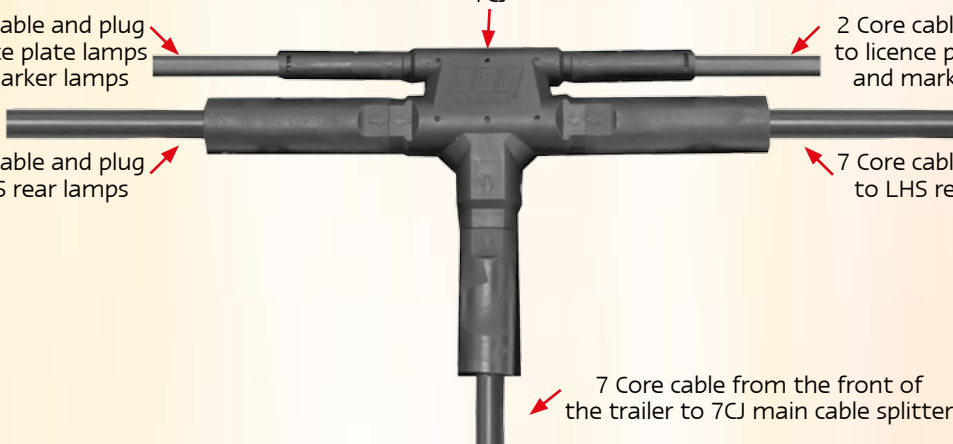

7CLC

7 Core extension to trailer base To be used when second trailer is required

2 Core cable and plug to licence plate lamps and marker lamps

7CJ

2 Core cable and plug to licence plate lamps and marker lamps

7 Core cable and plug to RHS rear lamps

7 Core cable and plug to LHS rear lamps

7CLC

7 Core cable from the front of the trailer to 7CJ main cable splitter

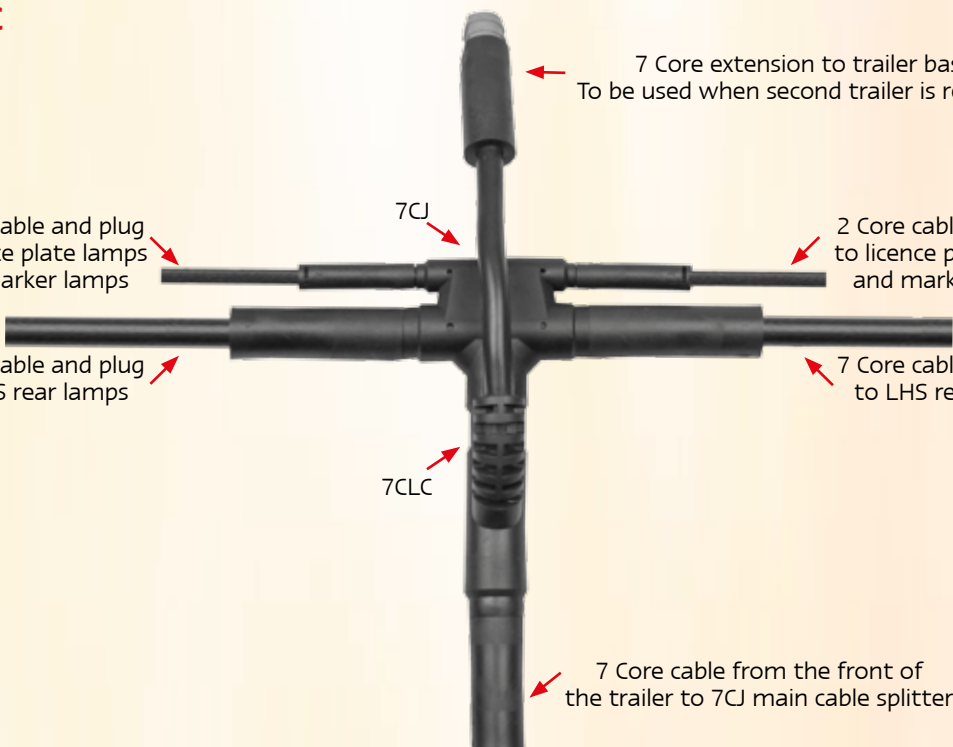

Heavy Duty Truck & Trailer Harness and Lighting System



Left & Right Indicator Lamp Splitter

Defined by its Yellow colour the 7CMI is a splitter from the 7 Core cable that power both the left and right hand side indicator lamps, the 7CMI has dual splitters at right angle to the 7 Core cable.

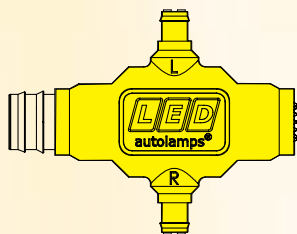

Part No. 7CMI Plug Dimension
Width 60mm, Length 78mm

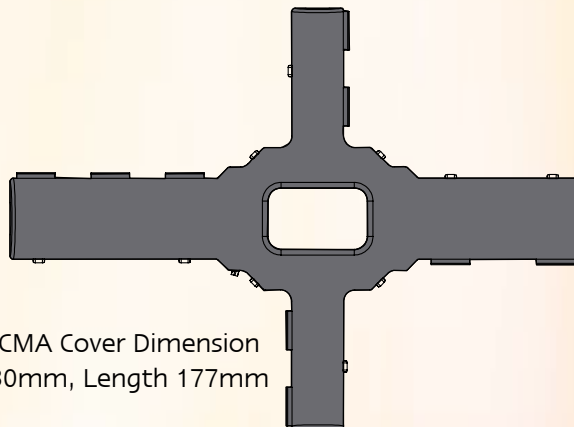

Part No. CMA Cover Dimension
Width 130mm, Length 177mm

Indicator Lamp Splitters

The 7CIL is a single splitter and runs parallel with the 7 Core cable and is used for left hand indicator. The 7CIR is a single splitter and runs parallel with the 7 Core cable and is used for right hand indicator.

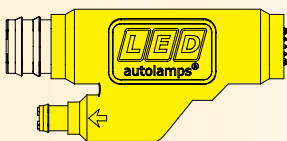

Part No. 7CIL Plug Dimension
Width 37mm, Length 78mm

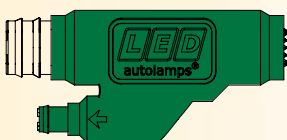

Part No. 7CIR Plug Dimension
Width 37mm, Length 78mm

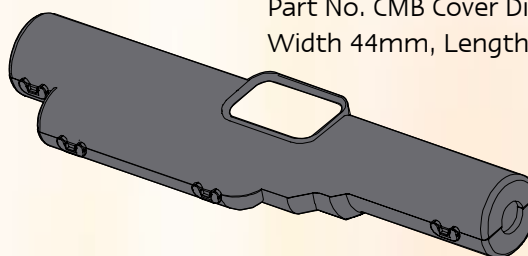

Part No. CMB Cover Dimension
Width 44mm, Length 177mm

Accessory Plug Individual Lamps

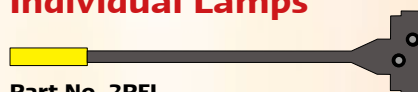

Part No. 2PFI
For use when using
recessed indicator lamps

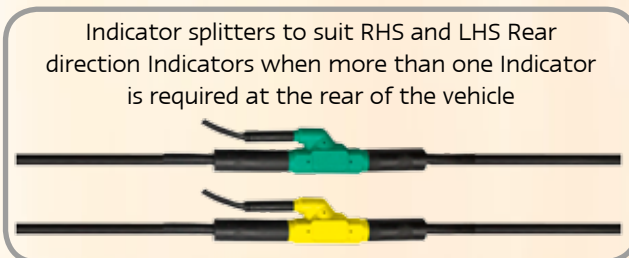
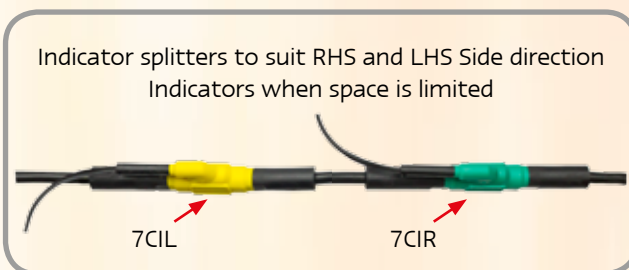
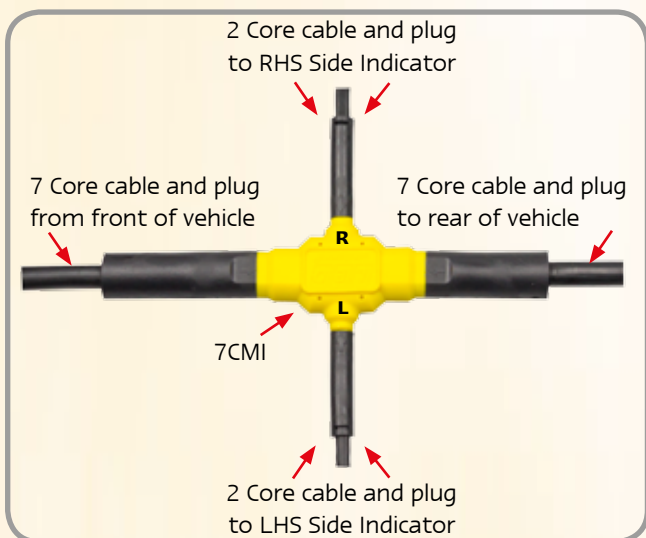

Heavy Duty Truck & Trailer Harness and Lighting System



Dual Marker Lamp Splitter

Defined by its brown colour the 7CMF is a splitter from the 7 Core cable that powers the marker lamps, the 7CMF has dual splitters at right angle to the 7 Core cable.

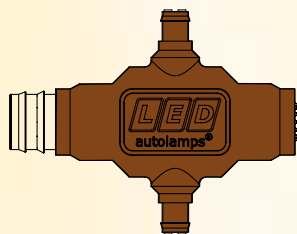

Part No. 7CMF Plug Dimension
Width 60mm, Length 78mm

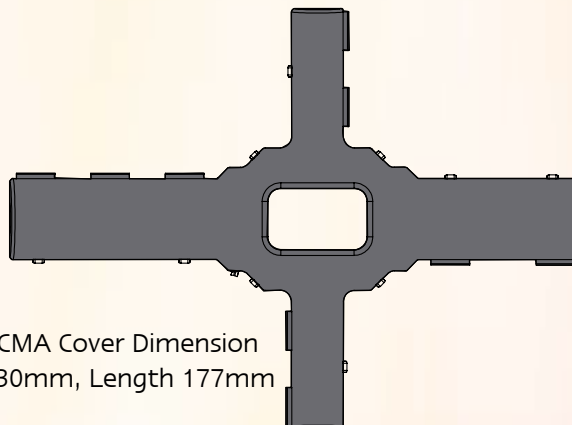

Part No. CMA Cover Dimension
Width 130mm, Length 177mm

Marker Lamp Splitter

The 7CF plug is a splitter that runs parallel with the 7 Core cable and powers the marker lamps.

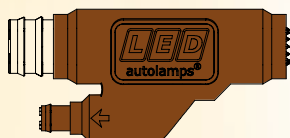

Part No. 7CF Plug Dimension
Width 37mm, Length 78mm

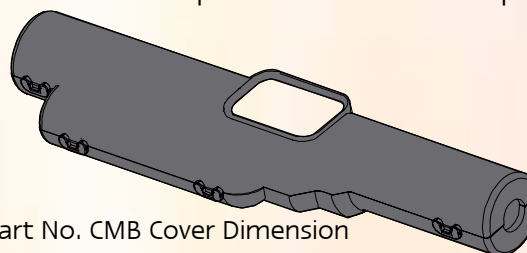

Part No. CMB Cover Dimension
Width 44mm, Length 177mm

2 Core Splitter Plug

The 2P3W is a plug that splits the marker cable into two, this allows the fitter to add as many marker lamps as required, always align the arrows on the plugs to ensure the correct connection.



Part No. 2P3W
To be used when more than one
Marker lamp is required.



Part No. 2P3C
Cover for the 2P3W.
Width 35mm Length 126mm

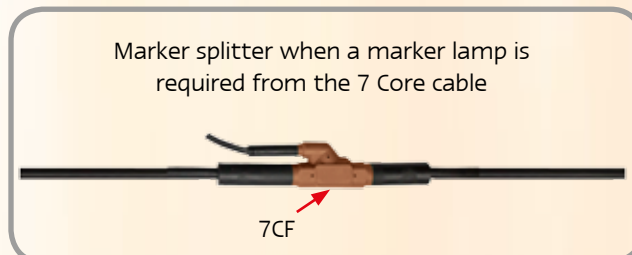
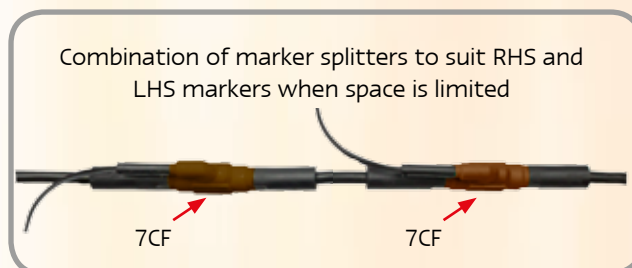
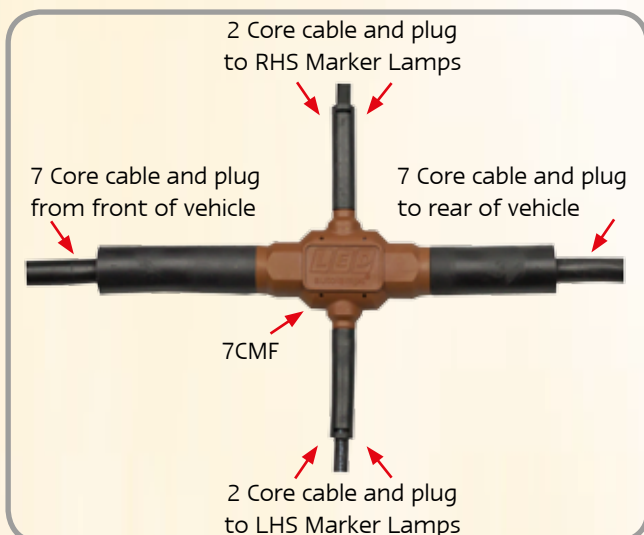

Heavy Duty Truck & Trailer Harness and Lighting System



Dual Brake Control or Accessory Splitter

Defined by its blue colour the 7CMB is a splitter from the 7 Core cable that power the brake control or any accessory when brake control is not required, the 7CMB has dual splitters at right angle to the 7 Core cable.

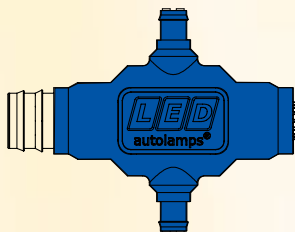

Part No. 7CMB Plug Dimension
Width 60mm, Length 78mm

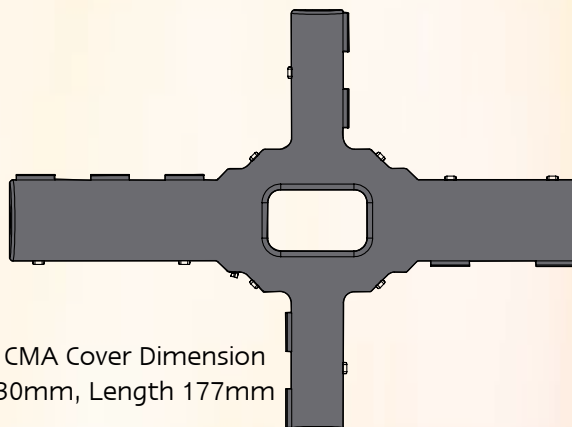

Part No. CMA Cover Dimension
Width 130mm, Length 177mm

Brake Control or Accessory Splitter

The 7CB plug is a splitter that runs parallel with the 7 Core cable and powers the brake control or any accessory when brake control is not required.

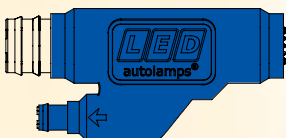

Part No. 7CB Plug Dimension
Width 37mm, Length 78mm

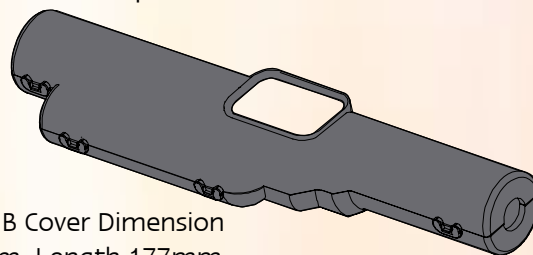

Part No. CMB Cover Dimension
Width 44mm, Length 177mm

2 Core Splitter Plug

The 2P3W is a 3 way plug that splits one cable into two, this allows the fitter to add as many accessories as required, always align the arrows on the plugs to ensure the correct connection.



Part No. 2P3W
To be used when more than one accessory is required.

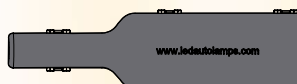

Part No. 2P3C
Cover for the 2P3W.
Width 35mm Length 126mm

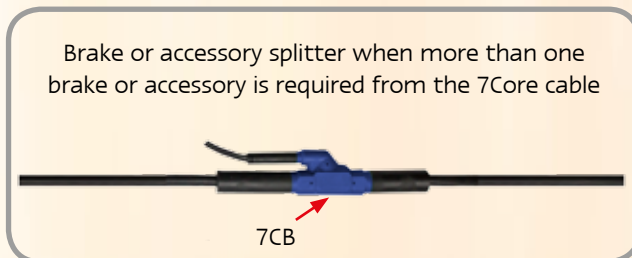
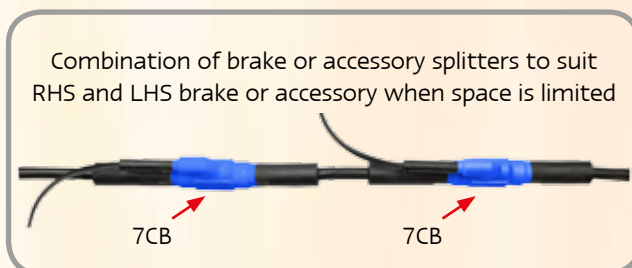
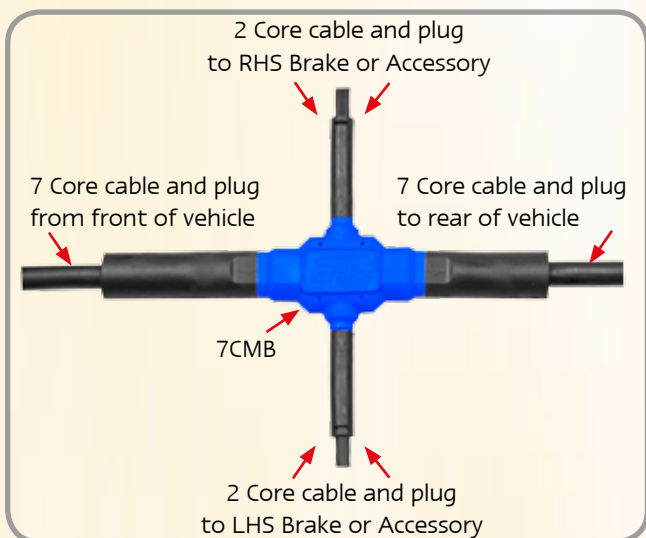

Heavy Duty Truck & Trailer Harness and Lighting System



Reverse Lamp Splitter

Defined by its black colour the 7CR plug is a splitter from the 7 Core cable that power the reverse lamps, work lamps or reverse beeper, the 7CF has a single splitter and runs parallel with the 7 Core cable.

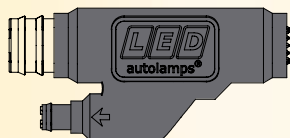

Part No. 7CR Plug Dimension
Width 37mm, Length 78mm

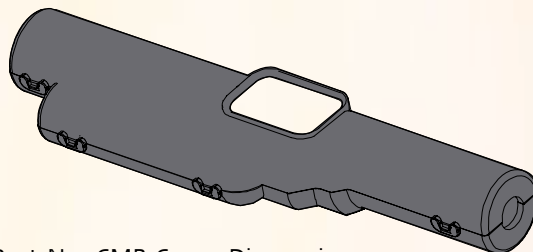

Part No. CMB Cover Dimension
Width 44mm, Length 177mm

2 Core Splitter Plug

The 2P3W is a plug that splits one cable into two, this allows the fitter to add as many reverse function products as required.



Part No. 2P3W
To be used when more than one lamp is required, connect to the black plug of the 7CR series.

Accessory Plug Individual Lamps



Part No. 2PF3
For use when using recessed reverse lamps

Accessory Products



Part No. 2PF200ET
Reverse Beeper.



Part No. 7312BMCS
ECE Approved Reverse Lamp



Part No. 7512BMCS
ECE Approved Reverse Lamp

Combination of splitters when more than one reverse lamp or beeper is required at the rear of the vehicle

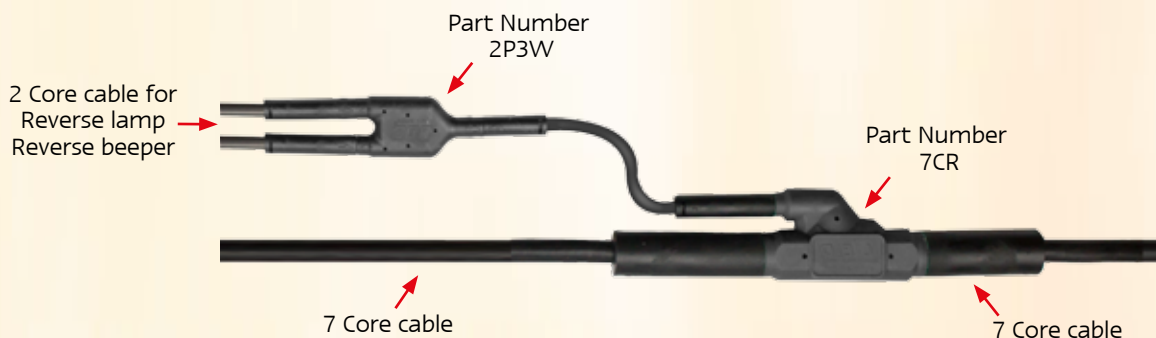

Heavy Duty Truck & Trailer Harness and Lighting System



Stop/Tail Lamp Splitter

Defined by its red colour the 7CST plug is a splitter from the 7 Core cable that power the Stop/Tail lamps. It can be used when more than one stop/tail lamp is required at the rear of the vehicle.

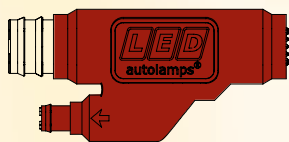

Part No. 7CST Plug Dimension
Width 37mm, Length 78mm

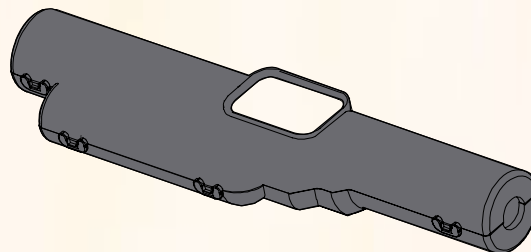

Part No. CMB Cover Dimension
Width 44mm, Length 177mm

3 Core Splitter Plug

The 3P3W is a plug that splits one cable into two, this allows the fitter to add as many Stop/Tail lamps as required, always align the arrows on the plugs to ensure the correct connection.



Part No. 3P3W
To be used when more than one stop/tail lamp is required.

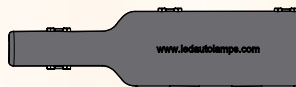

Part No. 2P3C
Cover for the 3P3W.
Width 35mm Length 126mm

Stop/Tail Lamp Extension

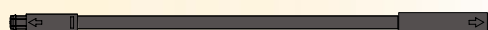

Part No. 3PFM.2
200mm Cable extension when using more than one stop & tail lamp

Accessory Plug Individual Lamps

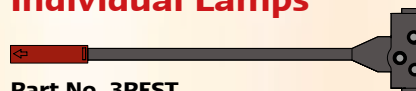

Part No. 3PFST
For use when using recessed stop/tail lamps

Combination of splitters when more than one Stop/Tail lamp is required at the rear of the vehicle

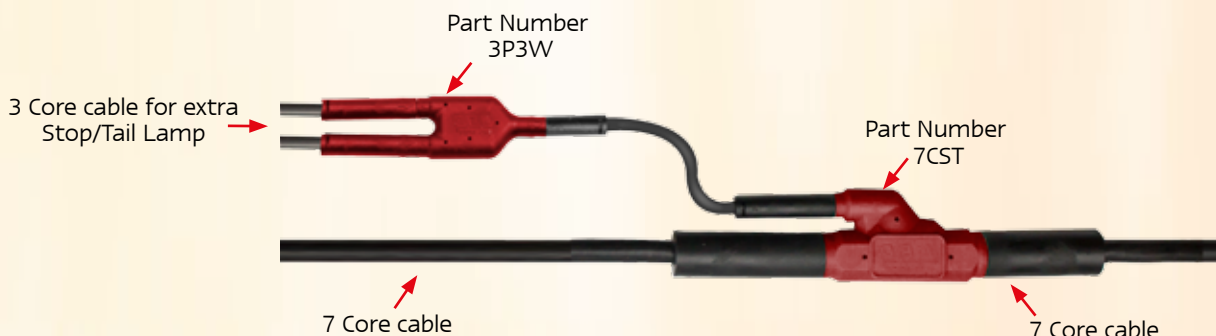

Heavy Duty Truck & Trailer Harness and Lighting System



Innovated Marker Cable System

The key to this system is its flexibility by offering every conceivable option for adding any marker from only one outlet buy using a specially designed water proof plug that splits one cable into two.

Flexibility

Cable lengths from 0.25m to 5m combining heavy duty connector covers for every plug and connector assembly point with a breaking strain in excess of 15kg, making this a heavy duty robust marker harness assembly.

DG Rating

Cables and covers are manufactured to comply with DG (Dangerous Goods) Rating. Inspected by worksafe Victoria and is accordance with DG-150424-1, DG-150424-2 in relation to the electrical wiring requirements as it applies to dangerous goods road vehicle bulk tankers, in accordance for usage with petrol and gas tankers. Cabling and lighting complies with AS2809 parts 1 & 2.

Labour Costs

Designed specifically to be easily and quickly installed without the need to cut, splice, solder, join or tape wire joins, reduces fitting times with its simple plug in design allowing skilled or non-skilled fitters to complete the install. Expect to reduce lighting assembly labour costs by up to 75% when using marker lamps fitted with 3M tape.

Warranty

Five Year Warranty for all truck and trailer vehicles and a one year warranty for livestock carrying trailers.

2 Core Marker Cable Specifications

The cable we have chosen for this harness system is used widely in the automotive industry and complies with SA-J1128 Standards, RoHs compliant and DG Rated.

The plugs we have designed are 100% water proof and pass IP68 Standards, our unique double ridged male plugs ensure complete water proofing by doubling the protection from water ingress.

The covers for the plugs have been created for extra strength at the join, engineered to a breaking strain of 15 kg.

These plugs have been designed with a special water proof sealing lip which will not allow water ingress

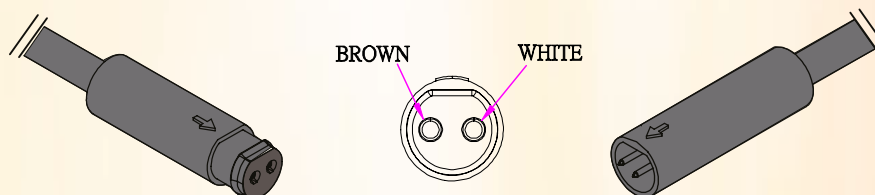

Cable Width 6mm, Male & Female plug Diameter 9mm, Combined length of plugs when joined 68mm

The cover for the plugs have been created for extra strength and engineered to a breaking strain of 15 kg.



Part No. 2PC, Cable Cover Dimension, Diameter 15mm, Length 72mm

Harness and Lighting System

Main Cable Splitter for Marker Lamp



Cable Lengths with Male and Female Plugs, use when adding 2 core cable lamps

Part No

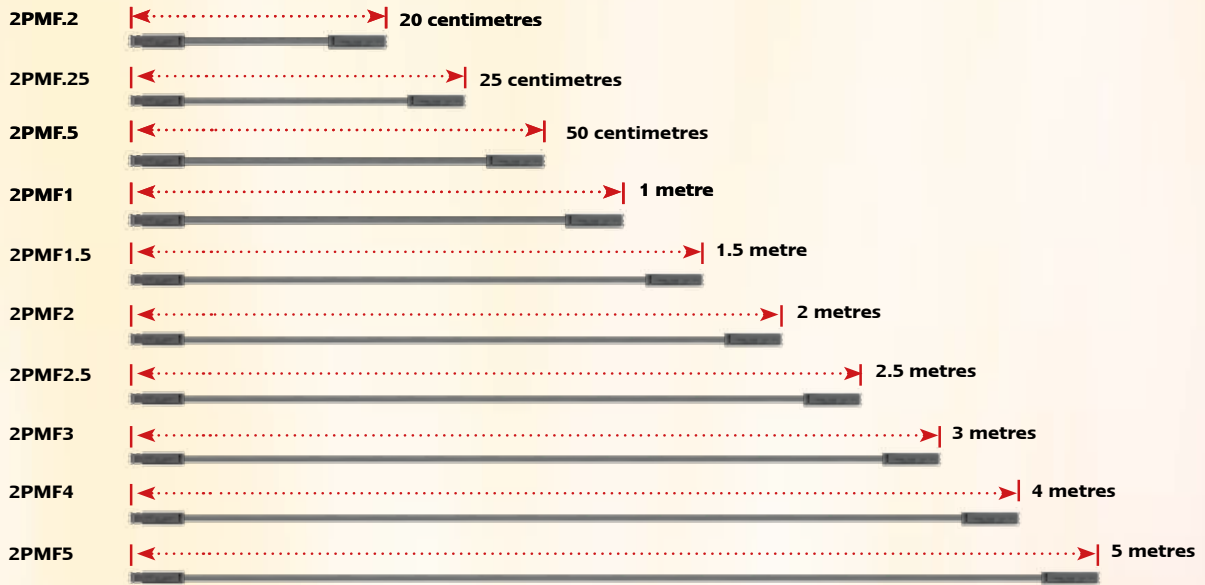

Cable Lengths with Female Plugs and bare wires, use when adding other brands

Part No

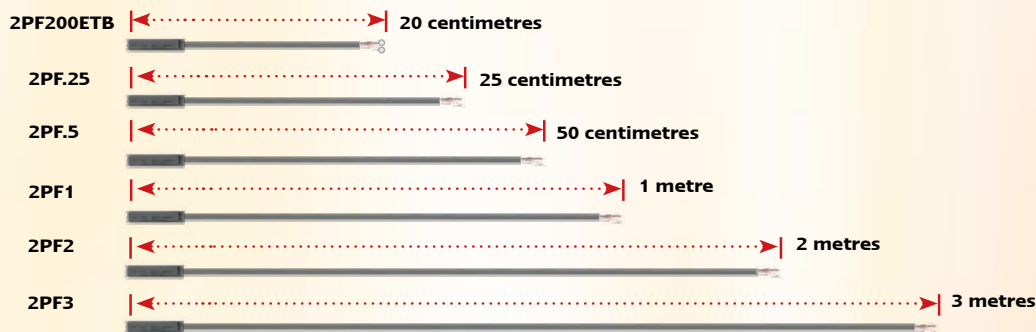

Cable Lengths with Male and Female Plugs, use when adding 3 core cable lamps

Part No

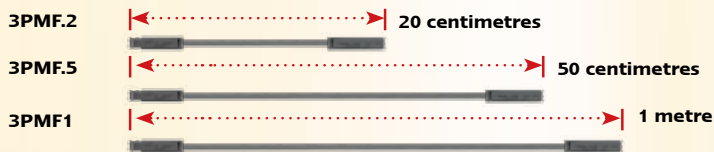

2 Core & 3 Core Splitter Plugs

The 2P3W and the 3P3W is a 3 way plug that splits one cable into two, this allows the fitter to add as many lamps as required, use with the above cable lengths.

2 Core Splitter



Part No. 2P3W

To be used when more than one lamp or accessory is required.

3 Core Splitter



Part No. 3P3W

To be used when more than one stop & tail lamp is required.

Splitter Cover

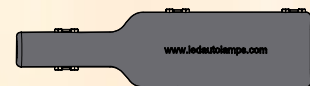

Part No. 2P3C

Cover for the 2P3W and 3P3W
Width 35mm Length 126mm

Harness and Lighting System Rear Combination Lamps



Function Stop/Tail/Indicator with Reflector Included		Size 282mm x 95mm x 28mm	
Part No	280ARRMLCSB	280ARRMRCSB	
Side	Left Hand Side	Right Hand Side	
Cable	200mm with Plug	200mm with Plug	
Packaging	Bulk	Bulk	
For Technical Information and Specifications Refer to Page 27 of our Main Catalogue or visit our website.			



Function Stop/Tail/Indicator with Reflectors				Size 460mm x 130mm x 33mm	
Part No	460ARRMLCS	460ARRMLCSB	460ARRMRCS	460ARRMRCSB	
Side	Left Hand Side		Right Hand Side		
Cable	200mm with Plug	200mm with Plug	200mm with Plug	200mm with Plug	
Packaging	Blister	Bulk	Blister	Bulk	
For Technical Information and Specifications Refer to Page 28 of our Main Catalogue or visit our website.					



Function Stop/Tail/Indicator with Reflectors				Size 595mm x 130mm x 45mm	
Part No	J3BARRMLCS	J3BARRMLCSB	J3BARRMRCS	J3BARRMRCSB	
Side	Left Hand Side		Right Hand Side		
Cable	200mm with Plug	200mm with Plug	200mm with Plug	200mm with Plug	
Packaging	Blister	Bulk	Blister	Bulk	
For Technical Information and Specifications Refer to Page 29 of our Main Catalogue or visit our website.					

Harness and Lighting System Rear Combination Lamps



Function	Stop/Tail/Indicator/Reverse with Reflector Included			Size	282mm x 95mm x 28mm
Part No	280ARWMLCS	280ARWMLCSB	280ARWMRCS	280ARWMRCSB	
Side	Left Hand Side		Right Hand Side		
Cable	200mm with Plug	200mm with Plug	200mm with Plug	200mm with Plug	
Packaging	Blister	Bulk	Blister	Bulk	
For Technical Information and Specifications Refer to Page 27 of our Main Catalogue or visit our website.					

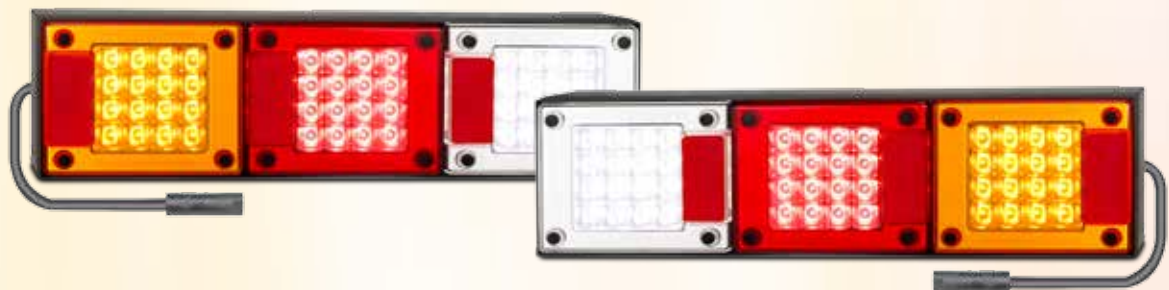

Function	Stop/Tail/Indicator/Reverse with Reflectors			Size	460mm x 133mm x 33mm
Part No	460ARWMLCS	460ARWMLCSB	460ARWMRCS	460ARWMRCSB	
Side	Left Hand Side		Right Hand Side		
Cable	200mm with Plug	200mm with Plug	200mm with Plug	200mm with Plug	
Packaging	Blister	Bulk	Blister	Bulk	
For Technical Information and Specifications Refer to Page 28 of our Main Catalogue or visit our website.					

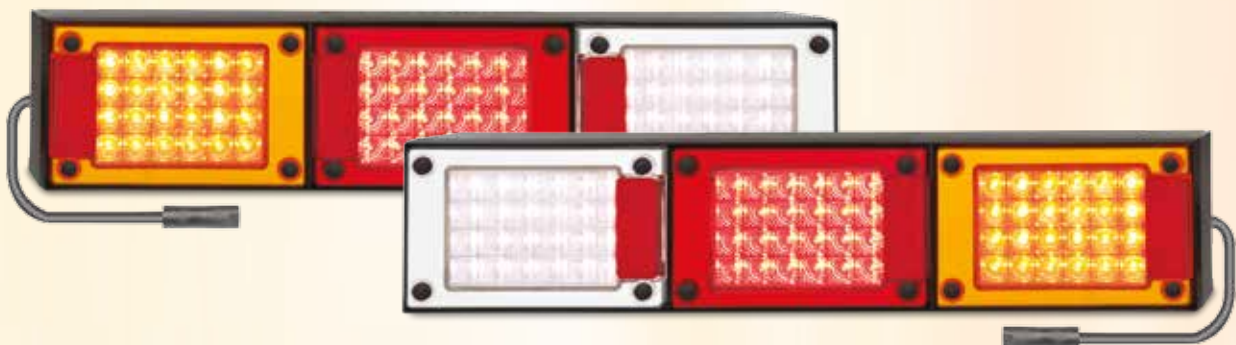

Function	Stop/Tail/Indicator/Reverse with Reflectors			Size	595mm x 130mm x 45mm
Part No	J3BARWMLCS	J3BARWMLCSB	J3BARWMRCS	J3BARWMRCSB	
Side	Left Hand Side		Right Hand Side		
Cable	200mm with Plug	200mm with Plug	200mm with Plug	200mm with Plug	
Packaging	Blister	Bulk	Blister	Bulk	
For Technical Information and Specifications Refer to Page 29 of our Main Catalogue or visit our website.					

Harness and Lighting System

Single Function Lamps with Adapter Plugs

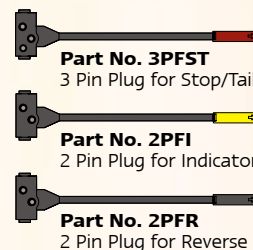

Function	Stop/Tail	Rear Indicator	Reverse
Part No	110RMB	110AMB	110WMB
Rubber Grommet	53101	53101	53101
Packaging	Bulk Poly Bag	Bulk Poly Bag	Bulk Poly Bag

For Technical Information and Specifications Refer to Page 34 of our Main Catalogue or visit our website.

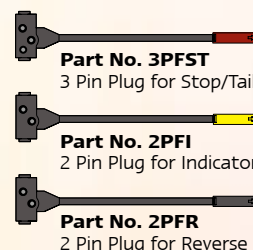

Function	Stop/Tail with Reflector	Rear Indicator	Reverse
Part No	130RMB	130AMB	130WMB
Rubber Grommet	59401	59401	59401
Packaging	Bulk Poly Bag	Bulk Poly Bag	Bulk Poly Bag

For Technical Information and Specifications Refer to Page 32 of our Main Catalogue or visit our website.

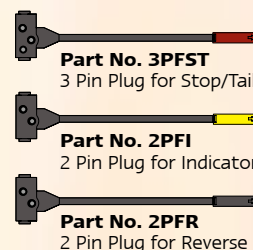

Function	Stop/Tail	Rear Indicator	Reverse
Part No	5490RM	5490AM	5490WM
Rubber Grommet	59401	59401	59401
Packaging	Bulk	Bulk	Bulk

For Technical Information and Specifications Refer to Page 32 of our Main Catalogue or visit our website.

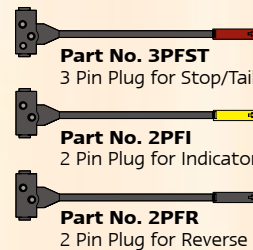

Function	Stop/Tail	Rear Indicator	Reverse
Part No	5590RMB	5590AMB	5590WMB
Rubber Grommet	59401	59401	59401
Packaging	Bulk	Bulk	Bulk

For Technical Information and Specifications Refer to Page 33 of our Main Catalogue or visit our website.

Harness and Lighting System

Single Function Lamps



Function	Stop/Tail	Indicator	Reverse
Part No	102RMCS	102AMCS	102WMCS
Cable	200mm with Plug	200mm with Plug	200mm with Plug
Packaging	Blister	Blister	Blister
For Technical Information and Specifications Refer to Page 35 of our Main Catalogue or visit our website.			



Function	Stop/Tail	Indicator	Reverse
Part No	132RMCS	132AMCS	132WMCS
Cable	200mm with Plug	200mm with Plug	200mm with Plug
Packaging	Blister includes grommet & plug	Blister includes grommet & plug	Blister includes grommet & plug
For Technical Information and Specifications Refer to Page 33 of our Main Catalogue or visit our website.			

Marker Lamps without Red/Amber Side Markers



Function	Rear End Outline, Side Marker, Front End Outline		Size 28mm Round x 5mm
Part No	181RMCSB	181AMCSB	181WMCSB
Cable	200mm/Plug	200mm/Plug	200mm/Plug
Packaging	Bulk	Bulk	Bulk
For Technical Information and Specifications Refer to Page 47 of our Main Catalogue or visit our website.			



Function	Rear End Outline, Side Marker, Front End Outline with Inbuilt Reflector		Size 100mm x 38mm x 13mm
Part No	EU38RMCSB	EU38AMCSB	EU38WMCSB
Cable	200mm/Plug	200mm/Plug	200mm/Plug
Packaging	Bulk	Bulk	Bulk
For Technical Information and Specifications Refer to Page 45 of our Main Catalogue or visit our website.			

Harness and Lighting System Marker Lamps



Function	Rear End Outline, Side Direction, Amber/Red Side Marker, Front End Outline						Size 50mm x 25mm x 21mm	
Part No	5025RMCS	5025RMCSB	5025AMCS	5025AMCSB	5025ARMCS	5025ARMCSB	5025WMCS	5025WMCSB
Cable	200mm	200mm	200mm	200mm	200mm	200mm	200mm	200mm
Packaging	Blister	Bulk	Blister	Bulk	Blister	Bulk	Blister	Bulk

For Technical Information and Specifications Refer to Page 39 of our Main Catalogue or visit our website.



Function	Rear End Outline, Side Direction, Amber/Red Side Marker, Front End Outline						Size 58mm x 35mm x 21mm	
Part No	58RMCS	58RMCSB	58AMCS	58AMCSB	58ARMCS	58ARMCSB	58WMCS	58WMCSB
Cable	200mm	200mm	200mm	200mm	200mm	200mm	200mm	200mm
Packaging	Blister	Bulk	Blister	Bulk	Blister	Bulk	Blister	Bulk

For Technical Information and Specifications Refer to Page 41 of our Main Catalogue or visit our website.



Function	Rear End Outline, Side Direction, Amber/Red Side Marker, Front End Outline						Size 70mm x 35mm x 20mm	
Part No	37RMCS	37RMCSB	37AMCS	37AMCSB	37ARMCS	37ARMCSB	37WMCS	37WMCSB
Cable	200mm	200mm	200mm	200mm	200mm	200mm	200mm	200mm
Packaging	Blister	Bulk	Blister	Bulk	Blister	Bulk	Blister	Bulk

For Technical Information and Specifications Refer to Page 38 of our Main Catalogue or visit our website.



Function	Rear End Outline, Side Direction, Amber/Red Side Marker, Front End Outline						Size 74mm x 38mm x 35mm	
Part No	42RMCS	42RMCSB	42AMCS	42AMCSB	42ARMCS	42ARMCSB	42WMCS	42WMCSB
Cable	200mm	200mm	200mm	200mm	200mm	200mm	200mm	200mm
Packaging	Blister	Bulk	Blister	Bulk	Blister	Bulk	Blister	Bulk

For Technical Information and Specifications Refer to Page 42 of our Main Catalogue or visit our website.



Function	Rear End Outline, Side Direction, Amber/Red Side Marker, Front End Outline with Reflector						Size 135mm x 38mm x 22mm	
Part No	38RMCSB		38AMCSB		38ARMCSB		38WMCSB	
Cable	200mm		200mm		200mm		200mm	
Packaging	Bulk		Bulk		Bulk		Bulk	

For Technical Information and Specifications Refer to Page 46 of our Main Catalogue or visit our website.

Harness and Lighting System ECE Approved Reverse Lamps



Function	Flood/Reverse Lamp 12 Watts	Size	75mm x 93mm x 30mm
Part No	7512BMCS		
Cable	40cm		
Packaging	Blister		
Lumen Output	Effective 489lm, Raw 660lm		
Current Draw	@13.8V 0.59A, @28V 0.27A,		

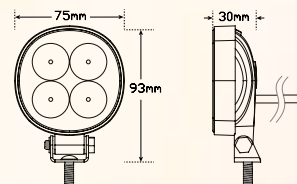
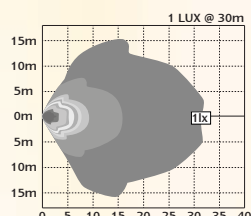

Function	Flood/Reverse Lamp 12 Watts	Size	73mm x 73mm x 31mm
Part No	7312BMCS		
Cable	40cm		
Packaging	Blister		
Lumen Output	Effective 489lm, Raw 660lm		
Current Draw	@13.8V 0.59A, @28V 0.27A,		

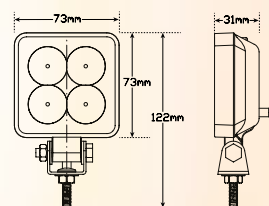
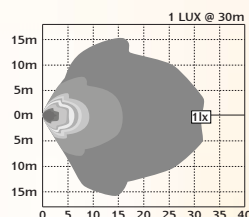

Harness and Lighting System ECE Approved Licence Plate Lamps

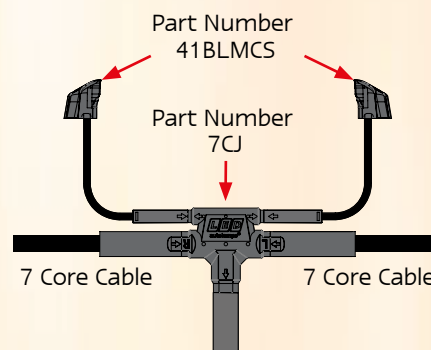

Function	Licence Plate Lamp	Size	70mm x 42mm x 40mm
Part No	41BLMCS	41BLMCSB	
Cable	200mm with Plug	200mm with Plug	
Packaging	Blister	Bulk	
Road Certification	ECE Licence Plate Lamp Approval No L-E9-00.1222 - Two required for ADR		
Current Draw	@13.8V 0.05A, @28V 0.04A,		

LED Autolamps Box, Tandem or Boat

Functional, Long Lasting Quality, Value for Money

Innovated Harness System

The key to this system is its ease of fitting. This enables wiring of a trailer to be completed faster which is perfect for trailer manufacturers, DIY or non skilled fitters saving time and money. No cutting, no soldering, no taping and a professional finish.

Flexibility

The system consists of individual cables for box trailers to large tandem trailers with cable lengths up to 8 metres and widths up to 2.1 metres. Boat trailer cables lengths available up to 12 metres in length. All cables have 2 core accessory plug that enable licence and marker lamps to be added if required.

Cable and Plugs

The Cables and plugs are specially designed with tinned copper terminals, special sealing plug ring and have water proof grease added for extra protection. All Cables and Plug sockets are IP67 rated ensuring a water tight fully submersible connection.



- Heavy Duty Water Proof Cable, Plugs and Connectors
- All Lights Compliant with ECE or ADR Road standards
- Cable plugs are IP67 rated, 100% water proof
- Rear lamps, markers and licence lamps are fully submersible
- 5 Year Warranty

Trailer Plug in Harness System

Quality Assured

This system has been on the market in excess of 10 years and continues to remain the popular choice for trailer manufacturers Australia wide. With a 10 year proven track record and a minimal failure rate well under 1%, you can be confident of a long lasting cabling and lighting solution.

Labour Costs

Designed specifically to be easily and quickly installed without the need to cut, splice, solder, join or tape wire joins, reducing fitting times with its simple plug in design allowing skilled or non-skilled workers to complete the install. Expect to reduce lighting assembly labour costs by up to 75%.

Licence Lamps and Connectors

Also available is the LP1 and 35BLM1P that have a 1 metre cable with a plug that fits into the back of the 100, 150 and 275 series lamps. The 99 and 149 have the licence plate lamp inbuilt with the 207 series licence lamps incorporated in its bracket

Warranty

Five Year Warranty when fitted as intended.

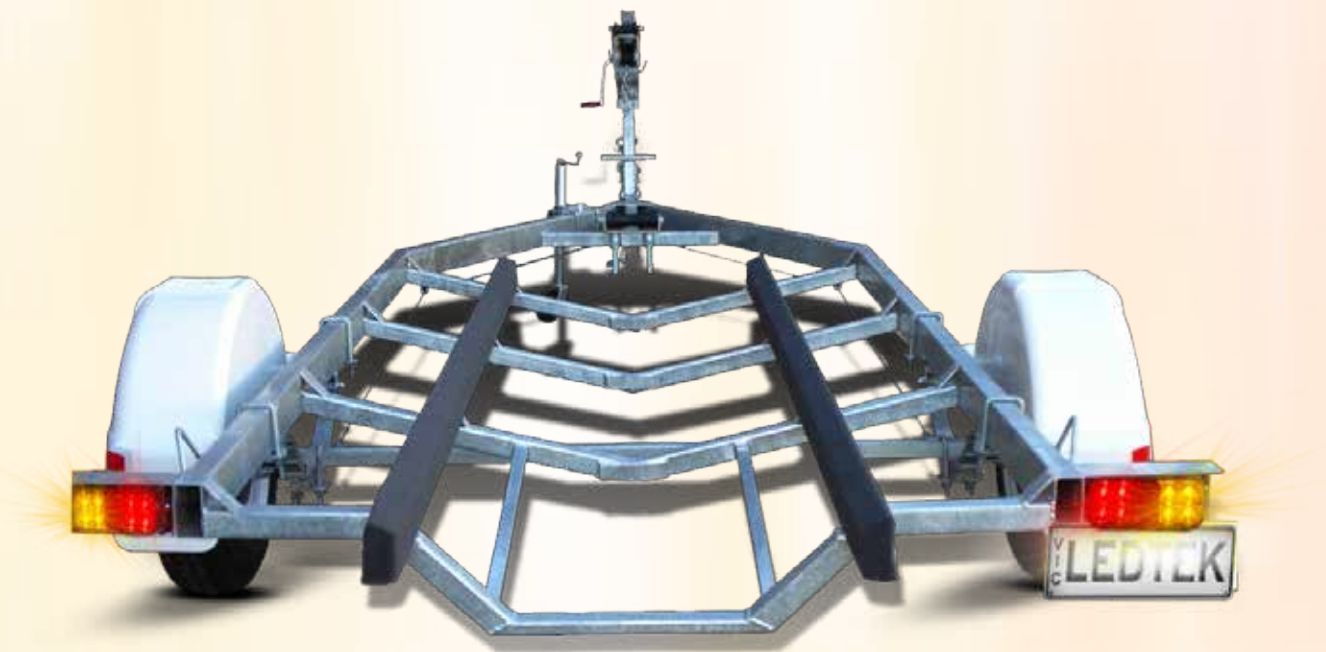

- No wiring or crimping tools required
- No cutting or splicing of wires
- No soldering of joins or connections
- No Joiners or taping required
- Professional finish

Cable system for small trailers with a 5 Year Warranty

- 100% waterproof
- Specially designed plugs
- No assembly tools required



Wiring of a trailer can now be done quickly and easily without cutting, splicing, joining or insulating wires & cables. The cables and plugs are specially designed with tinned copper terminals and water proof grease with IP67 rated plugs and sockets ensuring a water tight connection. All main cables have accessory wires at the ends of the male plugs which are compatible with the marker lamp plug in cable system. Cabling system comprises of the following:

- 1. Gooseneck to lamp** – this cable is fitted from the front of the trailers frame to the rear right hand lamp. The male plug to the lamp has two accessory wires for side markers.
- 2. Lamp to lamp** – this cable is fitted from the right hand lamp to the left hand lamp. The male plug to the lamp has two accessory wires for side markers.
- 3. Cable with trailer plug** – this 1 metre cable is fitted to the gooseneck to lamp cable, or the boat cable connector. This cable ends with a trailer plug. (7 pin flat, 7 pin round or 7 pin small round).
- 4. Marker lamp cable and connector** – For fitting compatible marker lamps to the trailer.
- 5. Licence lamp cable and connector** – LP1 and 35BLM1P have a 1 metre cable with a plug that fits into the back of the 100, 150 and 275 series lamps.

Cable system for trailers from 3.7 meters to 8 meters

Lamp to gooseneck cable

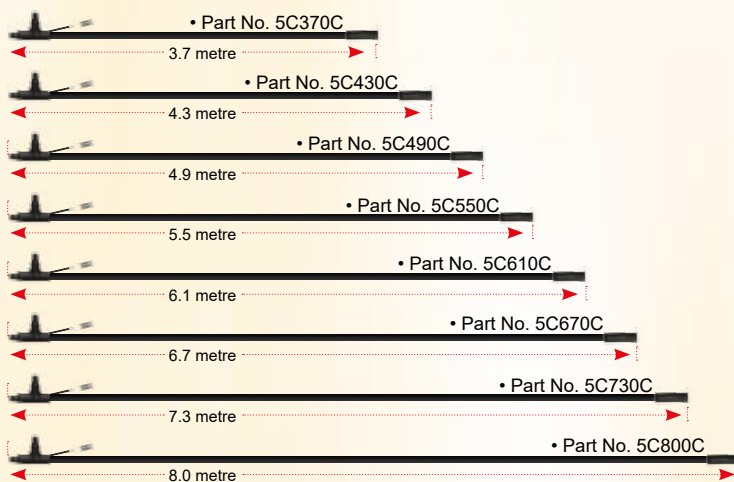

Lamp to lamp cable

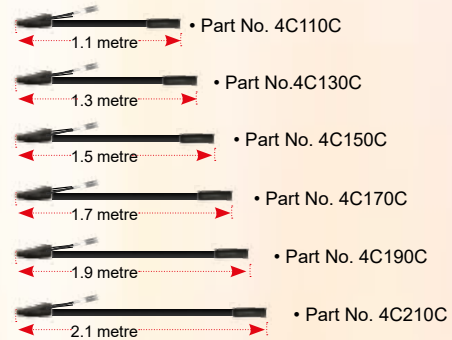

Gooseneck to car with trailer plug

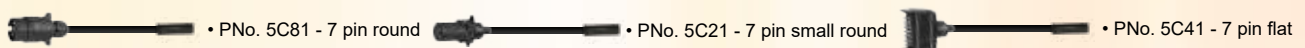

Marker Lamp Cables and Connector

Heavy duty marker lamp cables

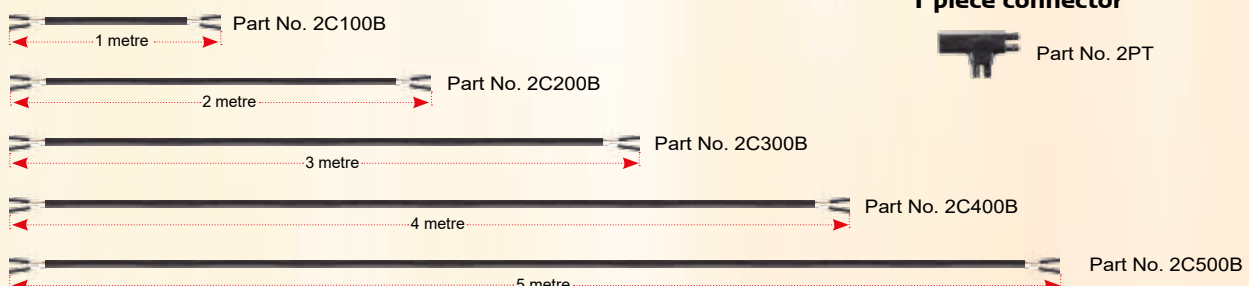

Cable system for small trailers with a 5 Year Warranty

- 100% waterproof
- Specially designed plugs
- No assembly tools required

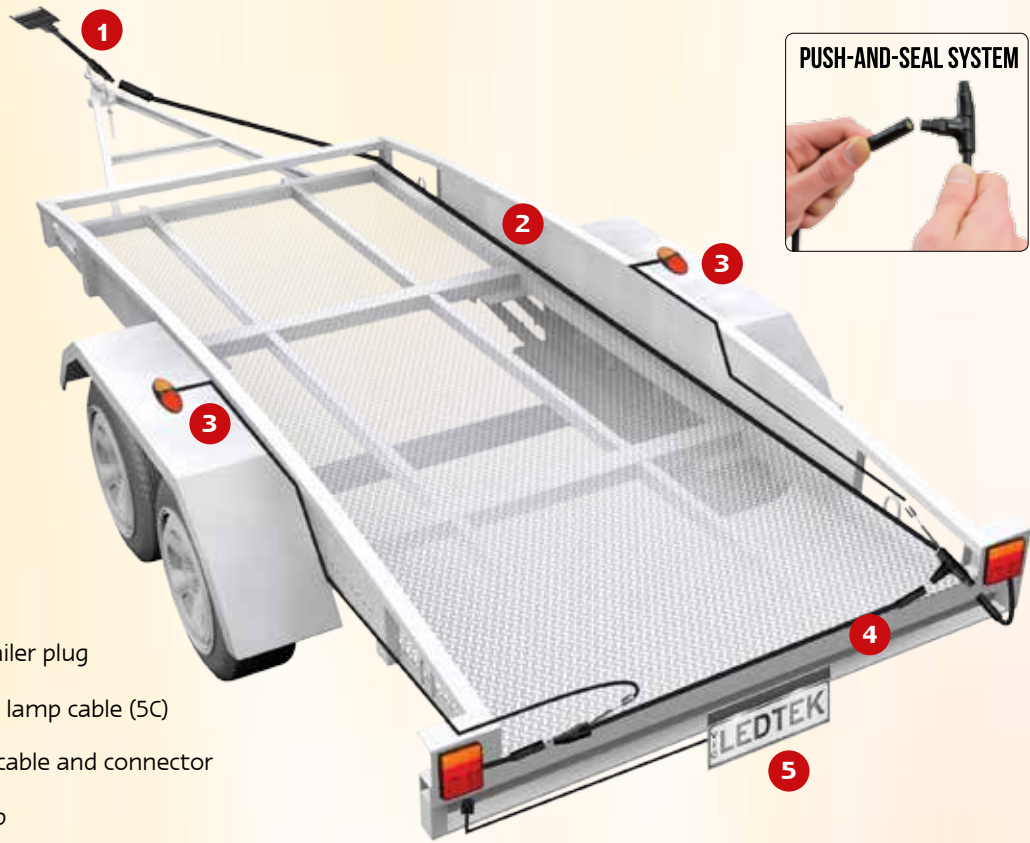

- 1 Cable with trailer plug
- 2 Gooseneck to lamp cable (5C)
- 3 Marker lamp cable and connector
- 4 Lamp to lamp
- 5 Licence lamp cable and connector

Plug in Cable Compatible LED Autolamps products



37 Series



58 Series



275 Series



100 Series

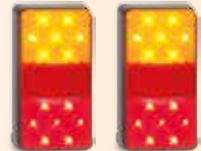

150 Series



35BLM1P



LP1



99 Series



149 Series

Available Box Cable Kits Up To 3.7 metres



Part No. TK6X4LR
Large round



Part No. TK6X4SR
Small round



Part No. TK6X4F
Flat



Part No. TK12X6LR
Large round



Part No. TK12X6SR
Small round



Part No. TK12X6F
Flat



Available Tandem Cable Kits Up To 5.5 metres

Cable system for boat trailers with a 5 Year Warranty

- 100% waterproof
- Specially designed plugs
- No assembly tools required



Wiring of a trailer can now be done quickly and easily without cutting, splicing, joining or insulating wires & cables. The cables and plugs are specially designed with tinned copper terminals and water proof grease with IP67 rated plugs and sockets ensuring a water tight connection. All main cables have accessory wires at the ends of the male plugs which are compatible with the marker lamp plug in cable system. Cabling system comprises of the following:

- 1. Boat trailer cable** - this cable connects each Individual lamp to the gooseneck area and plugs into the boat cable joiner. The male plug to the lamp has two accessory wires for side markers.
- 2. Boat cable connector** - this three way connector joins the left and right boat trailer cables to the cable with the trailer plug.
- 3. Cable with trailer plug** - this 1 metre cable is fitted to the gooseneck to lamp cable, or the boat cable connector. This cable ends with a trailer plug. (7 pin flat, 7 pin round or 7 pin small round).
- 4. Marker lamp cable and connector** - For fitting compatible marker lamps to the trailer.
- 5. Licence lamp cable and connector** - LP1 and 35BLM1P have a 1 metre cable with a plug that fits into the back of the 100 and 150 series lamps. The 99 and 149 have the licence plate lamp inbuilt with the 207 series licence lamps incorporated in its bracket.

Cable system for boat trailers from 4.0 meters to 12 meters

Boat trailer cable

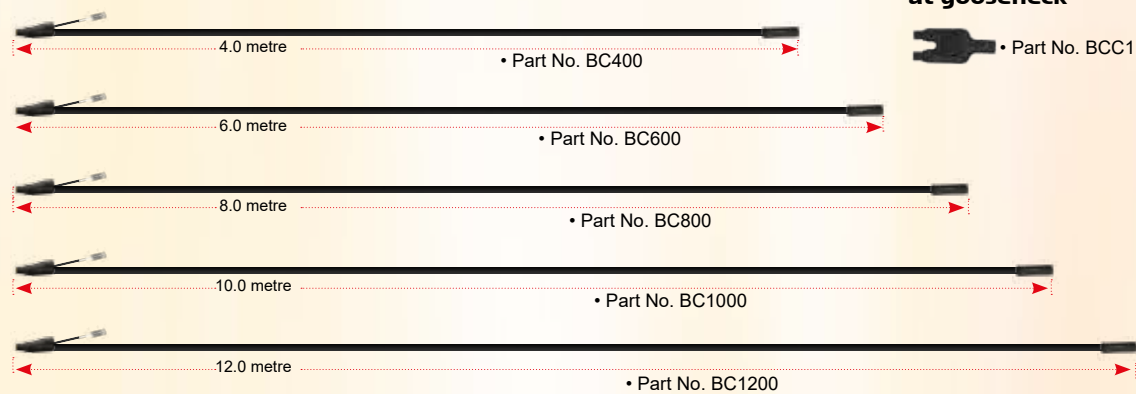

Joiner for left/right cable at gooseneck

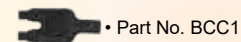

Gooseneck to car with trailer plug

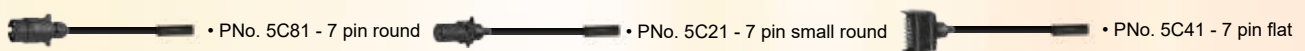

Marker Lamp Cables and Connector

Heavy duty marker lamp cables

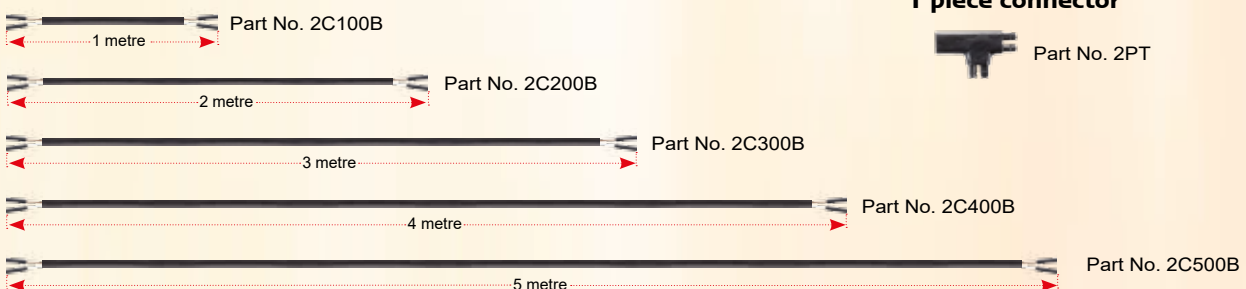

T piece connector



Cable system for boat trailers with a 5 Year Warranty

- 100% waterproof
- Specially designed plugs
- No assembly tools required

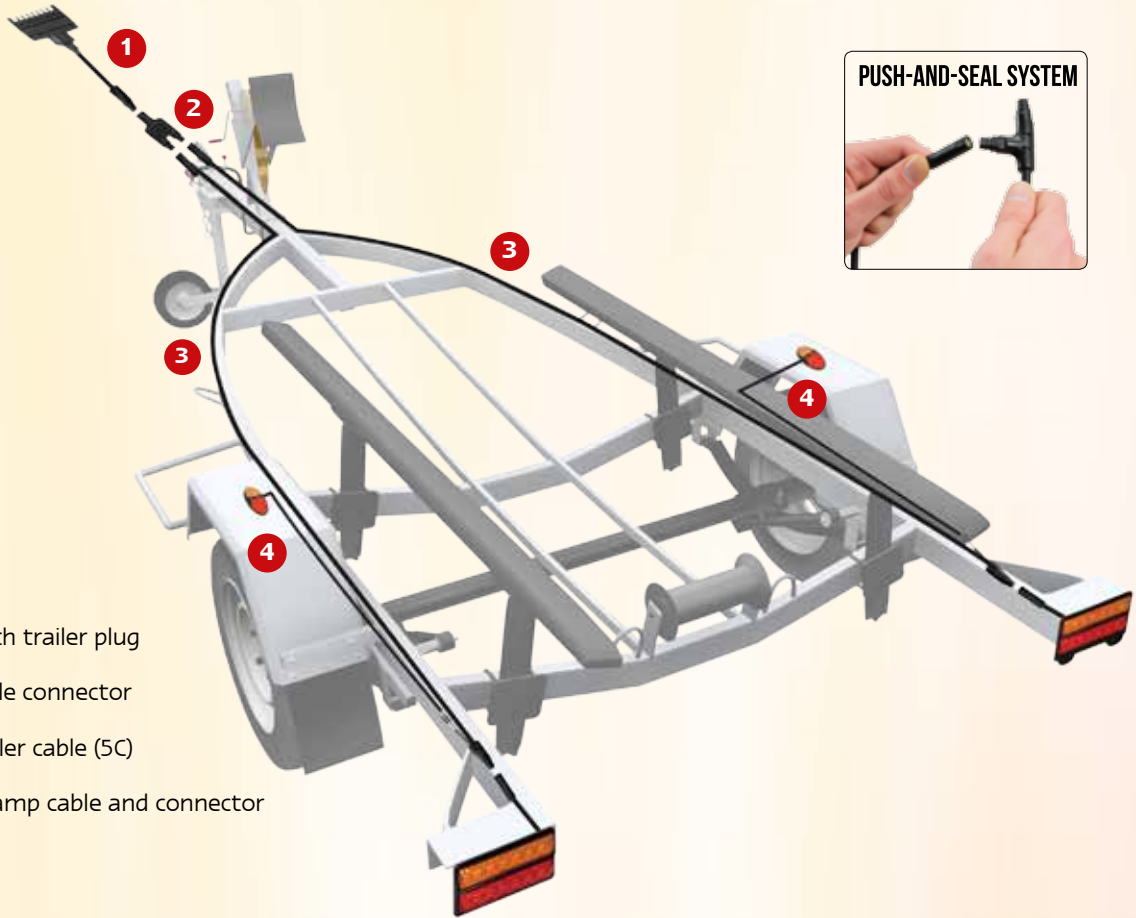

- 1 Cable with trailer plug
- 2 Boat cable connector
- 3 Boat trailer cable (5C)
- 4 Marker lamp cable and connector

Plug in Cable Compatible LED Autolamps products



37 Series



100 Series



99 Series



207BARLP2



58 Series



150 Series



149 Series



35BLM1P

Available 6 metre Cable Kits

Available 8 metre Cable Kits



Part No. BTk6LR
Large round



Part No. BTk6SR
Small round



Part No. BTk6F
Flat



Part No. BTk8LR
Large round



Part No. BTk8SR
Small round



Part No. BTk8F
Flat



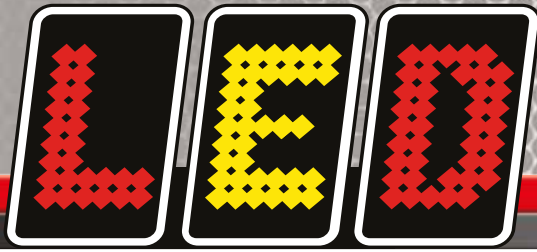

LED Technologies Pty Ltd

autolamps

42 Enterprise Drive, Bundoora

P.O. Box 2107 Bundoora

VIC 3083, Australia

(Phone) 03 9466 7075 (Fax) 03 9466 8112

(Email) led@ledtech.com.au

(international - phone) 61 3 9466 7075

(international - fax) 61 3 9466 8112

ABN 88 427 607 504

ACN 100 887 474

RE: LED Autolamps HARNESS SYSTEM - ISO 9001:2008 – No. QEC30099

This document is to certify that LED Autolamps Harness System (inclusive of cables, lighting and associated products) comply with the following Standards:

AS 2809.1-2008

Australian Standard

Road Tank Vehicles for Dangerous Goods

Part 1: General requirements for all road tank vehicles

All lighting has either been tested by NATA Accredited Laboratories & certified by Road Vehicle Certification System (RVCS) or has been certified by RVCS pursuant to the ECE certification system, and has been approved by Department of Infrastructure and Regional Development ("Authority"),

For the purposes of AS 2809.1-2008, the following definitions apply:-

1.5.2 ADR Approved, Approval

Approved by, or approval of, the Authority

1.5.3 ADR Authority

The Authority having statutory (legal) control over a particular aspect of a road tank vehicle

AS 2809.1-2008, AS 2809.2-2008

Road Tank Vehicles for Dangerous Goods

Part 2: Road tank vehicles for flammable liquids

2.6 Vehicle Cabling and Electrical Equipment

2.6.1 Application

The requirements of this Clause 2.6 shall apply when the cargo is flammable, or the tanker is to operate in hazardous areas.

Cables must be installed in accordance with the Australian Design Rules for Motor Vehicles and Trailers.

Cabling to the rear of the cabin must have protection complying with Clause 2.6.2.

Cabling to intrinsically safe equipment can be produced by means other than conduit.

2.6.2 Protection of Wiring

Cables outside and to the rear of the cabin shall be protected in accordance with AS/NZS 2053, Parts 1, 2 and 7 or AS D26 (flared fittings), or by an alternative means having at least equivalent effectiveness.

The cables used are a 7 core separately insulated annealed copper wires in compliance with ASTMB3 protected by a factory manufactured 9.5mm polyvinyl chloride casing using plasticisers for cable flexibility, which effectiveness exceeds AS/NZS 2053, Parts 1, 2 and 7 or AS D26 (flared fittings).

2.6.5 Cabling to hazardous areas of Zone 2

The cabling and fittings to the tanker rear of the cabin have weather-proof level of protection rated to IP67 standard. Fully molded sealing glands and sealing gland covers are used.

2.6.6 Cabling to hazardous areas of Zone 1

Cabling shall be suitable, or in conduit suitable, for Zone 1, together with any associated glands and junction boxes.

AS/NZS 2053 Parts 1, 2 and 7 or ASD26 does not apply to this Harness System as the cabling & fittings used are an alternative that exceeds equivalent effectiveness of conduits.

LED Autolamps will indemnify its customers against legal proceedings brought against any customer relating directly to non compliance of the LED Autolamps Harness System with AS 2809.1-2008 Australian Standard for Road Tanker Vehicles for Dangerous Goods.

**TONY OTTOBRE
MANAGING DIRECTOR**