

133 Series Single Function Rear Lamps

- Low Profile Recessed Fitting
- ECE Australian Road Approved
- IP67 Rated
- Dual Voltage 12/24 Volt
- 5 Year Warranty

ECE
Approved

IP67
Rated

5 Year
Warranty

Function	(Stop/Tail) (Indicator)(Reverse) Reflector
Size Grommet	113mm x 160mm x 12mm
Size Lamp	87mm x 135mm x 22mm
Voltage	12-24 Volt
LED Qty	4 (16 Reverse)
Cable	Plug 53102
Lens	Hardened Acrylic
Mounting	59401, 59401B, 59401C

Draw	Stop	Tail	Ind	Rev
@13.8V	0.10A	0.03A	0.10A	0.33A
@28V	0.05A	0.02A	0.05A	0.10A

Approvals	Function	Approval No.
ECE	Stop/Tail/Ref	02 R1-S1-E9-02IB.22025
ECE	Indicator/Ref	02 2a-E9-02IB.11331
ECE	Reverse/Ref	00 AR-E9-02IB.1060



Stop/Tail/Reflector
133RMG - Single Blister

Blister
Includes
Grommet
& Plug



Rear Indicator/Reflector
133AMG - Single Blister

Blister
Includes
Grommet
& Plug



Reverse/Reflector
133WMG - Single Blister

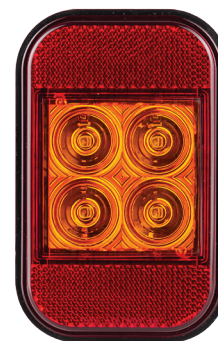

Rear Indicator/Reflector
133AMB - Light Only Bulk



Part No. 59401
Rubber Grommet



Part No. 59401C
Chrome Bkt



Part No. 53102
3 Pin Plug

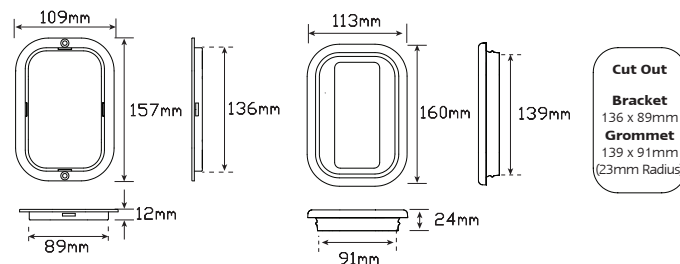

Fitting Instructions

Retro fit lamps. If new installation, fit grommet or flange into cutout (cut out 139 x 91mm, 23mm radius), plug 53102 wire into lamp and run through back then push into grommet/flange. Please refer to ADR 13/00 for mounting instructions.



All enquiries P: 1800 815 000 E: esgapcustomerservice@esg.global, www.ledautolamps.com

All efforts are made to ensure all information is correct and up to date, it can be subject to change without notice. All measurements are in millimeters (mm) and are not to scale.

All LED Autolamps designs are registered throughout the world. - Current as of 11/03/2025