

130 Series Single Function

**ADR
Approved**

**IP67
Protection**

**5 Year
Warranty**

- Recessed Mount
- ADR Road Approved
- IP67 100% Waterproof
- Voltage Range 12-24 Volt
- 5 Year Warranty



**Blister
Includes
Grommet
& Plug**



**Blister
Includes
Grommet
& Plug**



Stop/Tail/Reflector

130RMG - Single Blister
130RMB - Light Only Bulk

Rear Indicator

130AMG - Single Blister
130AMB - Light Only Bulk

Reverse

130WMG - Single Blister
130WMB - Light Only Bulk

Function	(Stop/Tail) (Indicator)(Reverse)
Size Grommet	113mm x 160mm x 3mm
Size Bracket	109mm x 157mm x 3mm
Voltage	12-24 Volt
LED Qty	14 (White 32)
Cable	Plug 53102
Lens	Hardened Acrylic
Mounting	59401, 59401C, 59401B

Draw	Stop	Tail	Ind	Rev
@13.8V	0.23A	0.03A	0.20A	0.15A
@28V	0.12A	0.04A	0.14A	0.08A

Approvals	Function	Category	CTA
ADR	Stop/Tail/Ref	49/00	060261
ADR	Indicator	6/00 Cat2a	060233
ADR	Reverse	1/00	060300

Fitting Instructions

Retro fit lamps. If new installation, fit grommet or flange into cutout (cut out 139 x 91mm, 23mm radius), plug 53102 wire into lamp and run through back then push into grommet/flange. **3-Pin Plug Wire Colours;** Red-Primary Function, Black-Tail, White-Earth. Please refer to ADR 13/00 for mounting instructions.



Part No. 59401
Rubber Grommet



Part No. 59401C
Chrome Bkt



Part No. 53102
3 Pin Plug

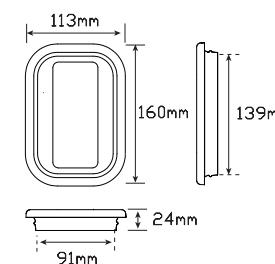
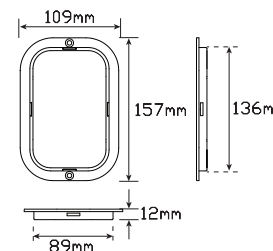

Cut Out
Bracket
136 x 89mm
Grommet
139 x 91mm
(23mm Radius)



All enquiries P: 1800 815 000 E: esgapcustomerservice@esg.global, www.ledautolamps.com

All efforts are made to ensure all information is correct and up to date, it can be subject to change without notice. All measurements are in millimeters (mm) and are not to scale.

All LED Autolamps designs are registered throughout the world. - Current as of 7/02/2024